

elliswilliams

Runcorn Community Housing Project

Feasibility Study



Document Details

Job Title Runcorn Community Housing Project
Document Title Feasibility Study
Document Code RCHP-EWA-XX-XX-RP-A-00001
Revision A
Issue Date 19/05/22

Project Lead James Leeson
Project Lead's Email James.Leeson@ewa.co.uk

Project Director Mark Evans
Project Director's Emails Mark.Evans@ewa.co.uk

Document Produced By James Leeson
Document Checked By Mark Evans
Document Issued To Design Team

Precedent Studies

Beneath the Flyover

The space beneath the flyover offers a unique opportunity for turning the oppressive space beneath the highway into a usable community space.

Climbing walls, skateparks, community parks and cafes are just a few of the potential uses for this space.



Underpass Uplift

Although the pedestrian underpass sits outside the site boundary there is an opportunity to enliven this space as it creates an important link between the site and the canal and wider town.

Improvements to lighting and a enticing art installation could lift the space and create a more inviting route to the new scheme.



Current underpass



Underpass lighting and art example

Site Layout - Option 1

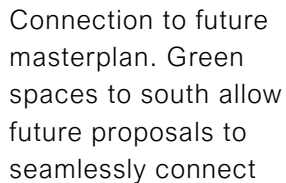

Sketch Proposal

Site Layout - Option 2

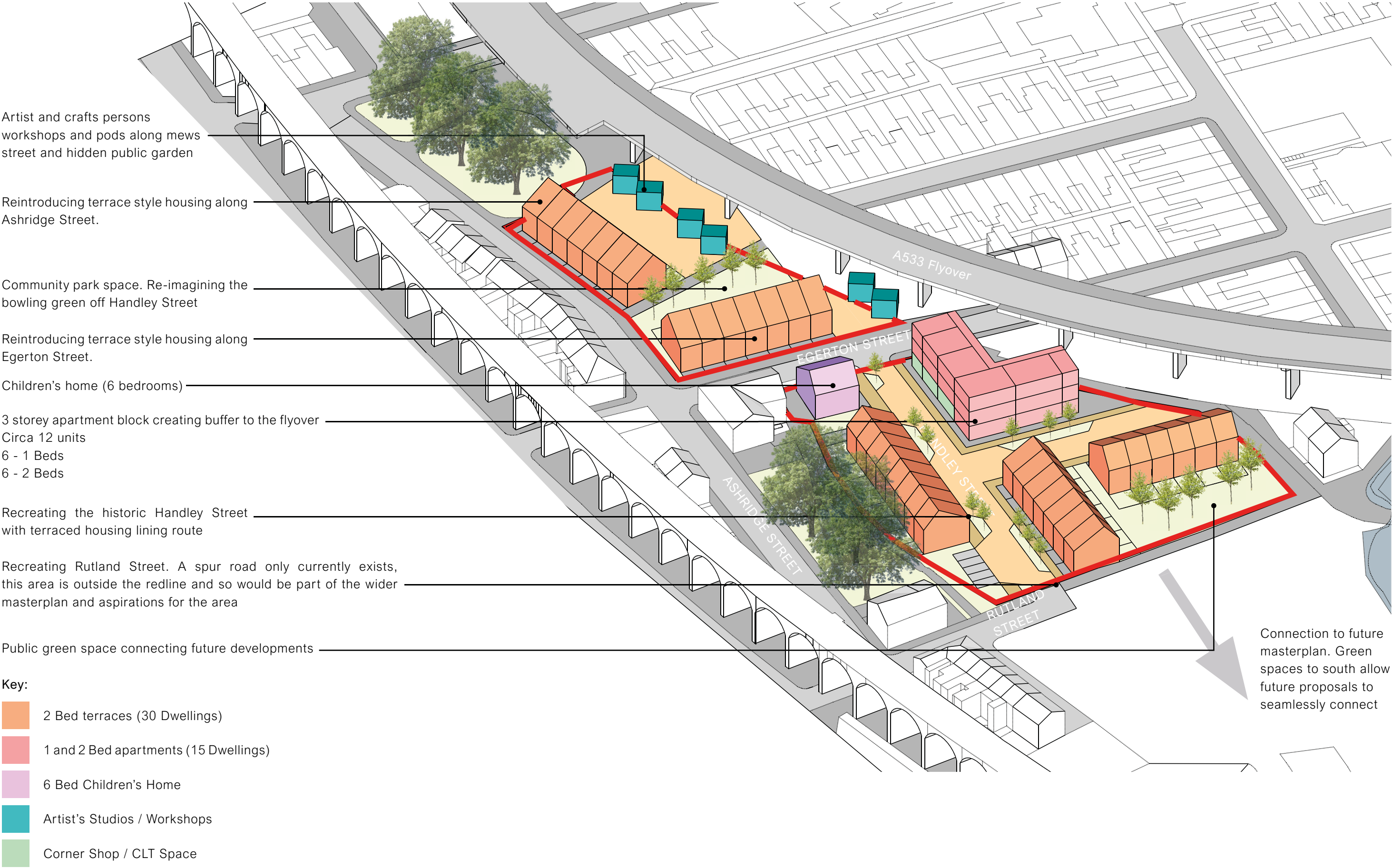

Sketch Proposal

Site Layout - Option 3

